

# Åbo Akademi University Library

Academill Library

7.1.2026 Linda-Marie Evertson



# The Finland-Swedish national library

- Over **2 million print books and journals** and **access to hundreds of thousands of e-books and e-articles!**
- ÅAUL is a **legal deposit library** and receives a copy of every book and journal printed in Finland.
- Two service units in Åbo (Astra and Arken), one in Vasa (Academill).
- **It's free for ÅAU students and staff to order books between Åbo and Vasa.**



# What can the library offer you?



Printed and electronic literature, e-resources



Support in your studies through courses and guidance



Group rooms and study places



Academill Library is a self-service library with extended opening hours



# Academill library

- Self service library with literature for the subjects at ÅAU in Vasa
- With a **HID key** you have access to the collections whenever the key is activated to Academill.
- **Check out and return books yourself**
- Staff is present at the service desk
  - **Mon-Wed, Fri 12.00-14.00**
  - **Thursdays 14.00-17.00**

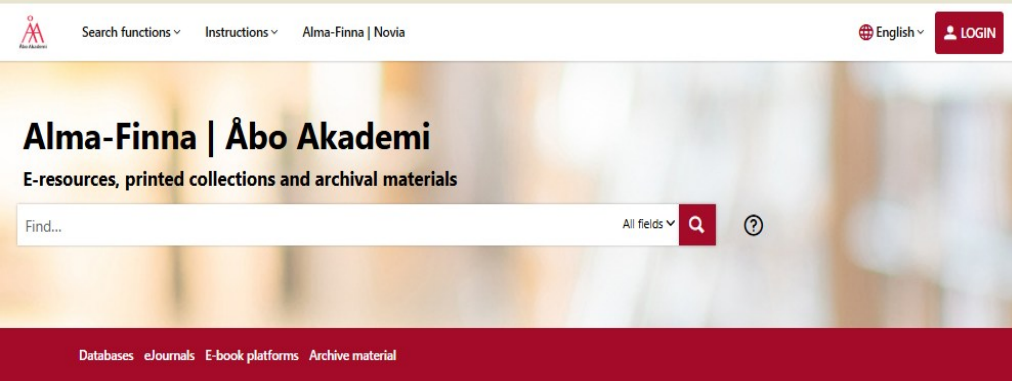

# Alma – the key to the collections



- In Alma (<https://abo.finna.fi>) you find both print and electronic material
- Reserve** checked out books, **request** from stacks or from Åbo, **renew** loans, **pay** fines...

**Opening hours**

Academii Library

**Closed now**

Week 02

5.1.	Mon	Closed
6.1.	Tue	Closed
7.1.	Wed	Closed
8.1.	Thu	14–17
9.1.	Fri	12–14
10.1.	Sat	Closed
11.1.	Sun	Closed

Entrance from the alley.

Collections are accessible when the building is open. Staff is present during service hours, see above.

ÅAU-affiliated with HID key have access to the collections whenever the key is activated.

Entrance from the alley.

Collections are accessible when the building is open. Staff is present during service hours, see above.

ÅAU-affiliated with HID key have access to the collections whenever the key is activated.

**Library website**

Read about the library's services.

**Library guides**

Explore the library's guides to support your studies, teaching and research.

**Guide for new students**

Read about how to get started using the library.

**Library e-resources**

Learn how to use the library's digital resources.

**Guide for information searching**

Learn how to search effectively.

**Archive collections**

Read about the archive's services and collections.

Rantakatu 2, 65100 Vaasa

Service unit information



# Get a library card in Tuudo!

1. Download the **Tuudo app** to your phone.
2. Log in with your ÅAU user name (HAKA)
3. Follow the instructions at **Library** (further instructions: [https://abo.finna.fi/Content/login\\_libcard#section4](https://abo.finna.fi/Content/login_libcard#section4) )
4. **Use the app as library card.** The barcode and PIN is needed when checking out with the self service machine.

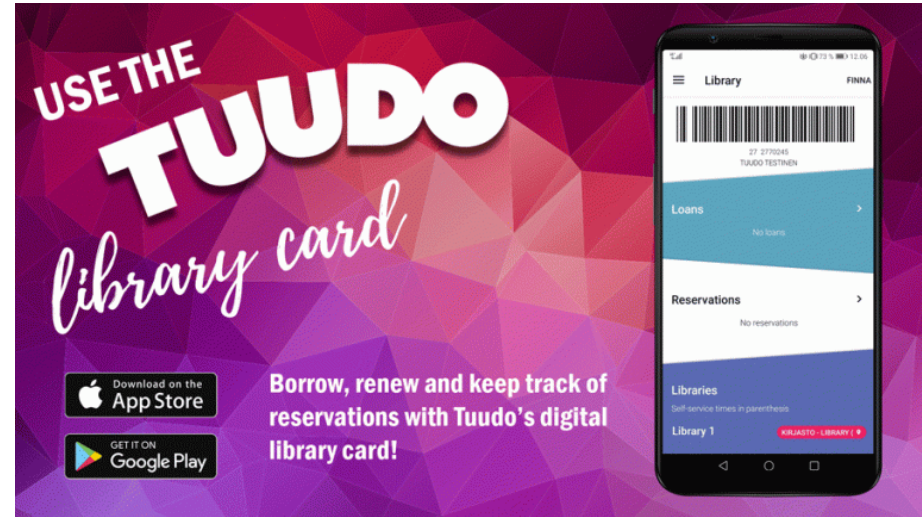

# Map of the Academill Library

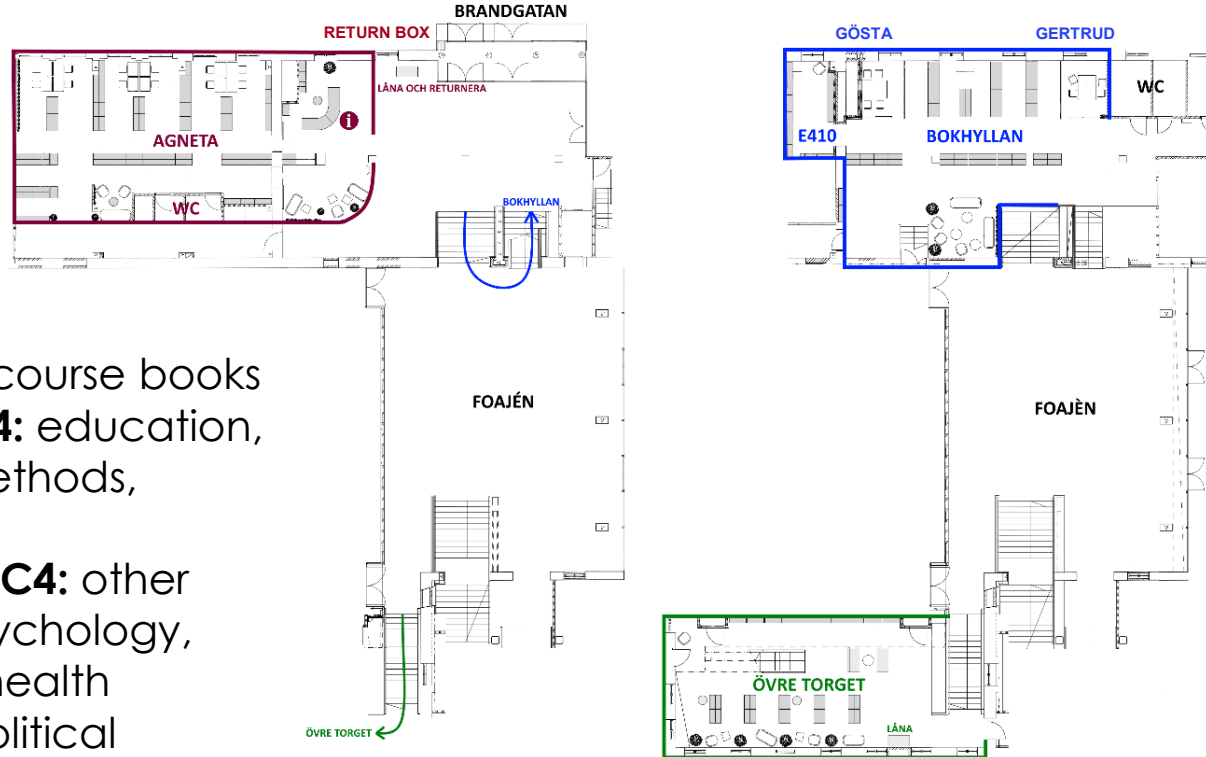

- **Agneta E3:** course books
- **Bokhyllan E4:** education, research methods, languages
- **Övre torget C4:** other subjects; psychology, social and health sciences, political sciences etc.



# How to borrow print material

- The books are in open shelves.  
**Check out and return with the self service machine!**
- **Loan periods:**
  - **14 days** course books/**1 day** short loans
  - **28 days** other collections
- The loans (except the short loans) are **automatically renewed** for **6/12 months**.



# Reserve books on loan

- If the book you want is on loan:
  1. Make a **reservation** in Alma.
  2. You will get an e-mail with a **pick up code** (e.g. HJ-E-32413) when the book is available
  3. Pick up the book from the **reservation shelf in Agneta** where the books are shelved according to the code
  4. Remember to **check out the book** at the self service machine!



# Overdue fees

- You get an **e-mail** when
  - Someone has reserved your loan = the book must be returned!
  - The book has been on loan for 6/12 months = come to the library and return or check out the book again
- Short loans must be returned the following day **at 12 o'clock**
- **Overdue fees**
  - **Course books: 1 €/day (at most 10 €/loan)**
  - **Short loans: 10 €/loan**
  - **Other loans: 0,30 €/day (at most 6 €/loan)**
- Your borrowing rights are suspended when fees amount to 10 €!  
Return overdue loans and pay the fees in Alma or at the service desk.

# Library guides

## Bibliotekets guider

SVENSKA ENGLISH

Åbo Akademi

- Guide for new students
- E-books
- Open Access-publishing
- Reference management tools
- Information searching
- Research data
- Research data management for students
- eGradu – Master's Thesis Evaluation Process
- Human Rights and International Law

Novia

- Guide for new students
- Business Administration, Turku
- Maritime Management
- Service Design
- Health and Welfare
- Novia eBooks
- Novia eArticles
- More Novia subject guides

Tillgänglighetsutlåtande | Accessibility statement | Logga in i Libguides (admin)

- There are both general guides and guides related to your field of study.
- In the guides, you will find help with locating literature and tips on how to search for information.
- **Guide for new students:**  
<https://libguides.abo.fi/c.php?g=721304&p=5237143>

# Contact us!

- **E-mail:** [library@abo.fi](mailto:library@abo.fi)
- [Library webpage](#)
- [Alma](#)
- [Libguides](#) – subject guides
- Follow us on social media!



facebook®



# Welcome!

